



**Bay and Bush  
Jervis Bay**

NATURE RETREAT · AUSTRALIA

Relax. Explore. Reconnect.  
[www.bayandbush.com.au](http://www.bayandbush.com.au)

# Business Events Fact Sheet

Escape to a Event of a Lifetime in the  
Stunning Coastal Gem of Jervis Bay (NSW)

Enquiries → [reservations@bayandbush.com.au](mailto:reservations@bayandbush.com.au)

CORPORATE · TEAMBUILDING · PRODUCT LAUNCH · PRIVATE EVENTS · INCENTIVE

Featured in:

AUSTRALIAN  
**Women's Health**



Well Traveller

Working with inbound tourism since 2020.



# Corporate Events Fact Sheet

www.bayandbush.com.au



## Reconnect, refresh, and realign—naturally

### Business unfolds in harmony with nature.

At Bay and Bush, business unfolds in harmony with nature. From **September 2025**, we welcome you to experience our brand-new function spaces—**The Mill Shed** and **The Nest**—crafted to host everything from strategic board meetings to immersive team retreats and elegant evening events. With flexible layouts and **capacities of up to 130 guests**, each space is equipped with modern **AV technology** and **reliable Starlink WiFi**, ensuring your team stays connected even in the heart of the bush. Your experience is elevated with **on-site catering** featuring fresh, locally sourced menus, and a new café space, also opening this spring, designed for relaxed networking and informal catch-ups. We also offer **ample on-site parking** and can **accommodate coach arrivals**, ensuring a smooth arrival for every guest.

### We understand the challenges of modern work.

Dispersed teams, digital fatigue, and the pressure to constantly innovate can leave people feeling disconnected and drained. Bay and Bush offers an antidote—a peaceful, nature-rich setting that inspires creative thinking, encourages collaboration, and helps your team reset. This is **more than just a meeting venue**—it's **a space for meaningful reconnection and purpose**.

### Where business meets bliss — sustainably.

Once the workday winds down, your team can retreat to our **7 cottages and 4 safari tents**, designed for comfort and calm in the heart of the Australian bush. With National and Marine Parks on our doorstep, every stay feels like a true escape. Guests can also take part in our **daily program of wellness experiences**—from yoga to bushwalks—offering balance and restoration beyond the boardroom. As proud supporters of sustainable travel, we provide **on-site EV charging**, follow **eco-conscious practices**, and are committed to preserving the natural beauty that surrounds us.



Team Building  
Retreats



Conferences &  
Seminars



Training  
Workshops



Product or Service  
Launches



Board / Shareholder  
Meetings



Year-End Functions &  
Company Milestones







## Function Areas

**Dynamic spaces to host  
conferences, team building  
activities, social dining, casual  
networking and more**



### THE HALL AND RAW BAR

The "Lobby" with its beautiful decor and polished concrete floor is a versatile indoor space with a lounge area and its fireplace. It is ideal for small gathering such as dining, cocktails, workshop breaks and networking.

The "Raw Bar" offers snacks, drinks and barista coffee.





## Function Areas



### EUCALYPT WELLNESS CENTRE

The "Eucalypt Wellness Centre" is a flexible space that holds groups up to 30 people in "u" shape. Tables, chairs, projector, whiteboards and more props can be allocated for smaller meetings and conferences. Accessible through the Lobby and formal lawn.







## Function Areas



### THE MILL SHED

The "Mill Shed" is a versatile space that can cater for large gatherings. The space holds 60 people sitting down and up to 70 people standing up for a cocktail occasion..

A marquee can be hired to extend the function space as well as a large 10 meters diameter Tipi Tent that can be placed on the lawn area.







## Add-ons

**Boost your delegates' wellbeing with wellness add-ons and local activities during your event**



### WELLNESS

#### Massages treatments:

- Individual Massage 45min
- Pilbara Hot Stone Massage 45min
- Reef Wave Massage (deep tissue) 45min

#### Facial treatments:

- Anti-Ageing Facial 45min
- Brightening Facial 45min

#### Yoga/Pilates/QiGong Private Sessions:

- Yoga and Guided Meditation Session 60min
- Pilates Stretch Session 60min
- QiGong Session 60min



### LOCAL ACTIVITIES

#### Explore Jervis Bay's nature with:

- Sea Kayaking 3hrs
- Freediving 4hrs
- Stargazing and Storytelling 90min
- Bushwalking and bush tucker 3hrs





## Destination

### Shoalhaven South Coast

#### "Many experiences, one destination"

The Shoalhaven is bordered by the mountains, coastal plains and 100 magnificent beaches, which includes 49 towns and villages with **great surf beaches, amazing bushwalks, local culture and our many annual food, wine and arts festivals and events.**

**Shoalhaven**  
SOUTH COAST - NSW



Huskisson, 5 min. drive from Bay and Bush Jervis Bay



[www.shoalhaven.com](http://www.shoalhaven.com)

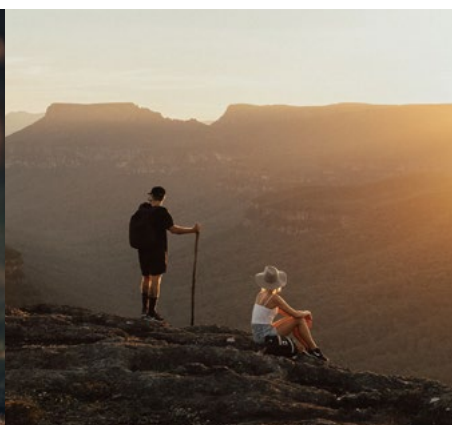





## Cottages

**The property has a total of 7 cottages located in 27 acres in the midst of the Australian bush, catering for couples, solo travellers, friends and groups**



### ROOM INCLUSIONS

- 7 single occupancy, or up to 33 shared occupancy
- All rooms have a private bathroom with a walk-in shower and some also with a spa bath (6 cottages)
- Private verandahs with gas BBQ
- Tea (T2) and coffee making facilities (Nespresso)
- Smart TV with Netflix and Chromecast
- Free high-speed Starlink WiFi
- Reverse-cycle air-conditioning and ceiling fans
- Hair dryer. Iron and ironing board
- Linen, towels and beach towels provided
- Complimentary breakfast hamper
- Sustainable and Australian-made amenities







## Safari Tents

**Embrace the natural beauty of a glamping experience without compromising on comfort staying at our four brand new Safari Tents**



### ROOM INCLUSIONS

- 4 single occupancy, or up to 8 shared occupancy
- Deluxe Safari Tent ensuite with bath, Queen Bed
- Room size 25m<sup>2</sup> (interior), Deck size 70m<sup>2</sup> (exterior)
- Complimentary breakfast hamper
- Kitchenette and dining area
- Private bathroom with shower and bath
- Private verandahs with a gas BBQ
- Tea (T2) and coffee making facilities (Nespresso)
- Free high-speed Starlink WiFi in communal areas
- Reverse-cycle air-conditioning and ceiling fans
- Linen, towels and beach towels provided
- Sustainable Australian-made amenities
- Free Parking
- Wildlife surrounding the property

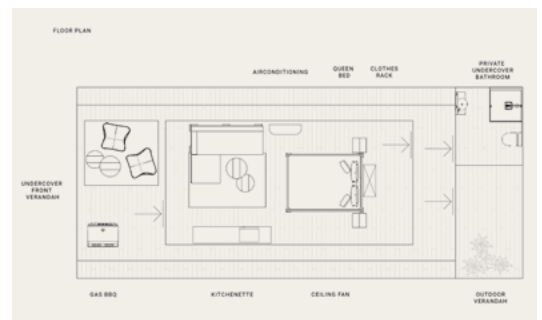





Guest Experience





# Corporate Events Fact Sheet

[www.bayandbush.com.au](http://www.bayandbush.com.au)



Get in touch

**If you have any questions or  
require additional information**

**Address:**

21 Pritchard Avenue, Woollamia, 2540 NSW, Australia

**Call or message us at:**

+61 (0)2 4444 6879 / +61 (0)414 149 940

**Email us:**

[reservations@bayandbush.com.au](mailto:reservations@bayandbush.com.au)

**Website:**

[www.bayandbush.com.au](http://www.bayandbush.com.au)



**Bay and Bush  
Jervis Bay**  
AUSTRALIA

**OPENING HOURS**

Mon-Sat from 9:30am to 5pm

Sun and Public Holidays from 10am to 2pm

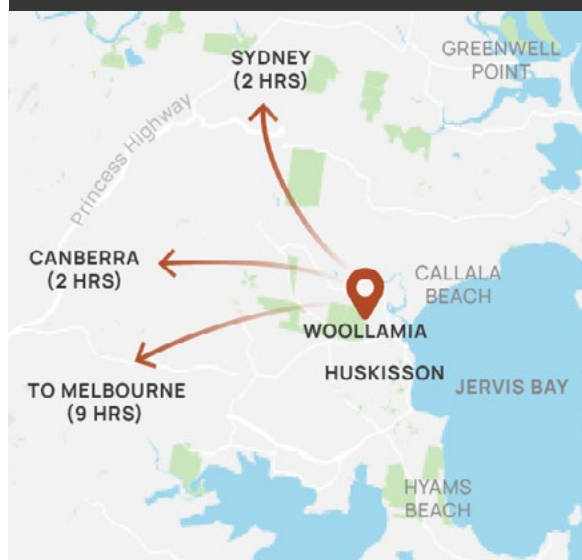

Enquiries → [reservations@bayandbush.com.au](mailto:reservations@bayandbush.com.au)

Husky Beach, 7 min. drive from Bay and Bush Jervis Bay

