



WILLINGA PARK

CONFERENCES

---

# CONFERENCES, EVENTS & ACCOMMODATION

---

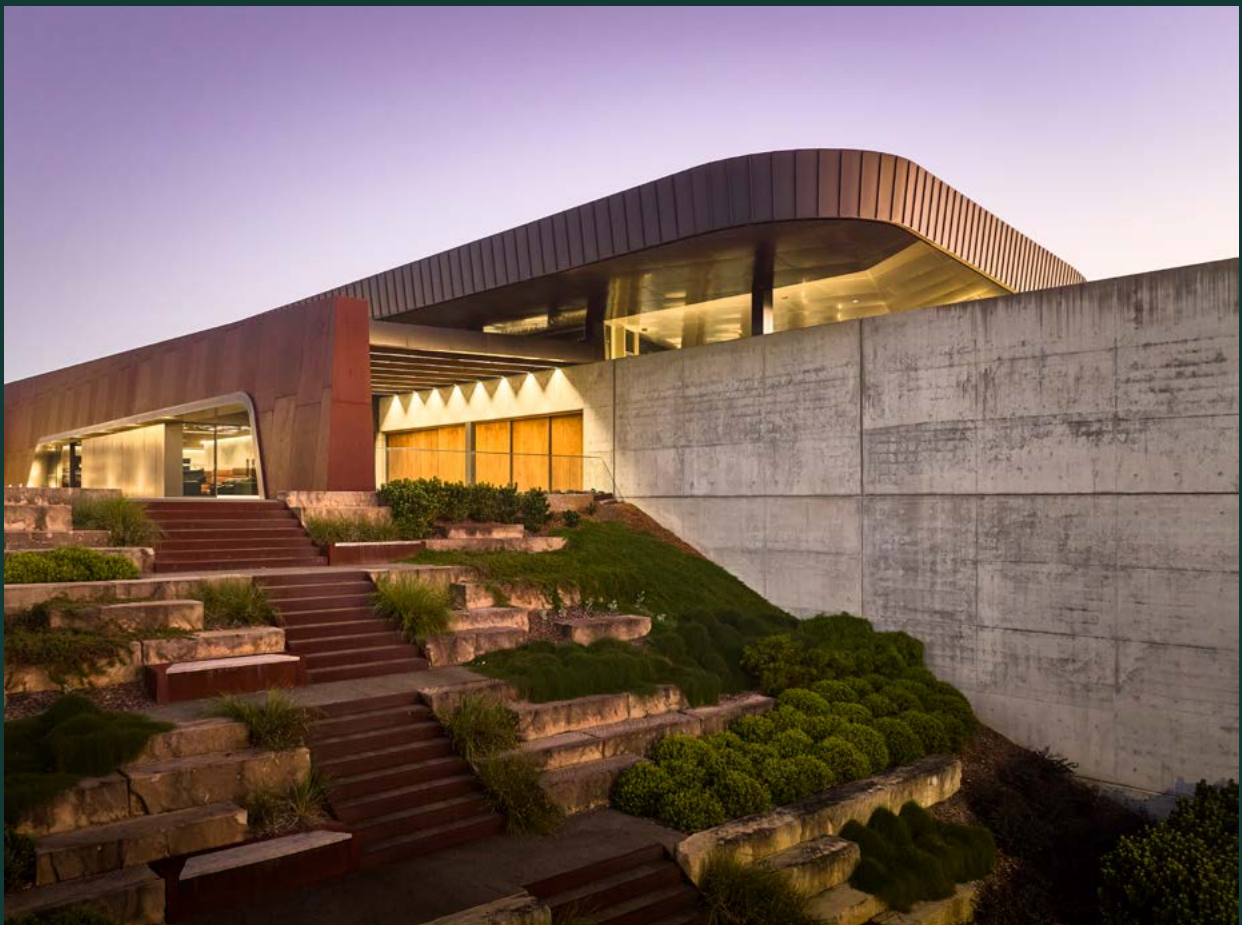

[WILLINGAPARK.COM.AU](http://WILLINGAPARK.COM.AU)



[facebook.com/willingapark](https://facebook.com/willingapark)



[@willingapark](https://instagram.com/willingapark)









CONFERENCING  
MEETS UNSPOILT,  
NATURAL LANDSCAPES.





# DISCOVER LUXURY AND BEAUTY INTERTWINED AT WILLINGA PARK.

Australia's premier Equestrian Centre and Events and Conference destination. Discover luxury and beauty intertwined at Willinga Park.

Willinga Park, nestled in Bawley Point on the stunning New South Wales South Coast, is a scenic haven merely hours from Canberra and Sydney airports.

Set on over 2,300 acres, the conference centre stands alongside our world-class equestrian facilities. The multi-purpose venue is complemented by award-winning architecture, state-of-the-art conferencing and meeting facilities, luxury accommodation and refined catering, all surrounded by unspoilt, natural landscapes.

Flexible meeting and breakout spaces allow us to create engaging experiences for you and your delegates. Whether you're working through the day's agenda in the breathtaking Conference Hall, dining in the relaxed atmosphere of The Stables Restaurant, or taking in the modern architecture in the Grand Prix Lounge, our team will work with you to tailor your experience.

Our venue is more than just a space; it is an immersive experience tailored for those who seek inspiration and innovative solutions that will foster meaningful connections and collaboration within your group.

To recharge or engage your team, explore more than 10 acres of botanical gardens and discover over 30 art sculptures scattered throughout the park during self-guided walks. Take on the hiking trails, mountain bike tracks, or the fully equipped gymnasium, and relax at the end of the day by the heated swimming pool.

Join us in our commitment to sustainability. Willinga Park features one of Australia's largest private solar panel 1,200-kilowatt micro-grids, a 2.1-megawatts Tesla battery storage system, a state-of-the-art water recycling system, and MVA diesel generators spread across three engines to provide alternative power.

Elevate your corporate escape with the unmatched excellence at Willinga Park, which will inspire big ideas and unleash innovation in style.

**We look forward to welcoming you to Willinga Park soon.**













# THE CONFERENCE HALL

---

The main feature of the conference centre is a breathtaking, architecturally designed, 350sqm Conference Hall, bathed in natural light and transforming effortlessly to suit your needs.

---

With a 10m x 3.5m LED screen, and two secondary side screens and wireless presentation capabilities, your events will surpass the ordinary.

Featuring flexible layouts and fully adaptable conferencing equipment, as well as options for staging and lighting, this exceptional space can host a range of events, from small to medium scale conferences, corporate retreats, meetings, functions, gala dinners and expos.

With floor-to-ceiling windows, opening to a 230sqm balcony with natural landscape views, this space will elevate your event and impress your delegates.





# THE CONFERENCE HALL

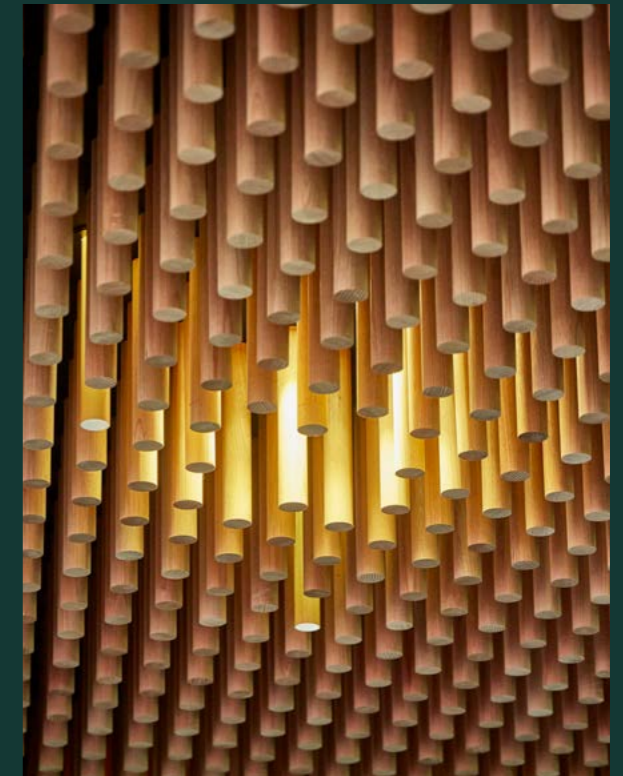

Theatre	250 pax
Cocktail	250 pax
Banquet	160 pax
Cabaret	112 pax
Trade Stalls	18

## Features

### WIFI

10m x 3.5m LED screen

Two 3.6m x 1.4m secondary side screens

Wireless presentation capabilities

Room system automation from touch panel

6m x 4m adjustable stage

Lectern

Roaming and lapel microphones

Touch-control lighting

Adamson IS7 sound system





# THE CONFERENCE HALL

Theatre setting

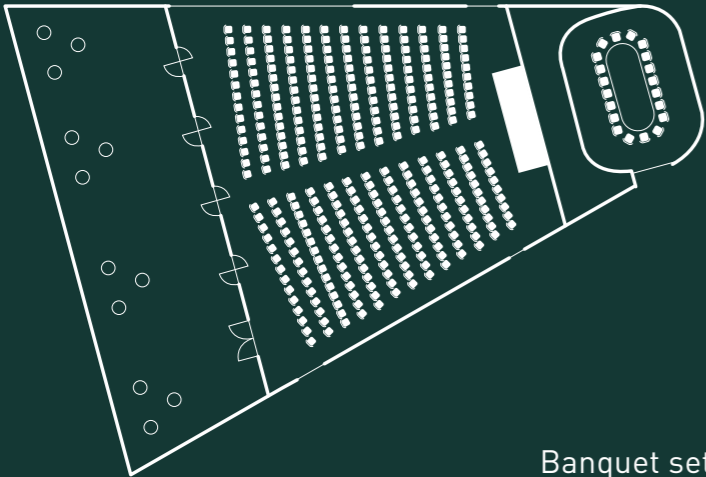

Banquet setting

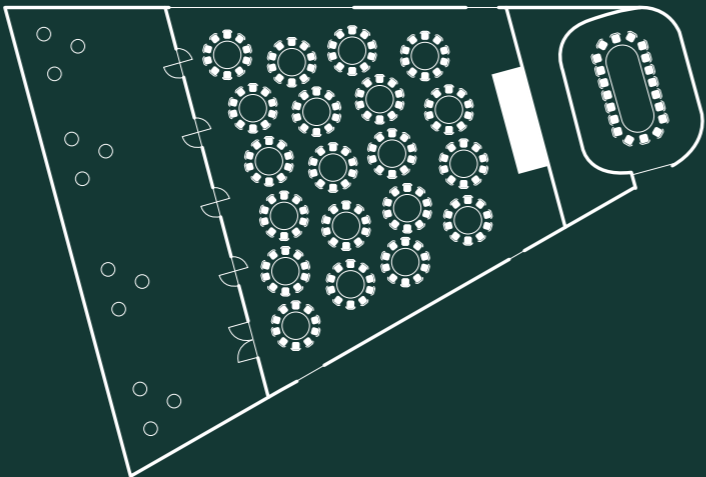

Cabaret setting

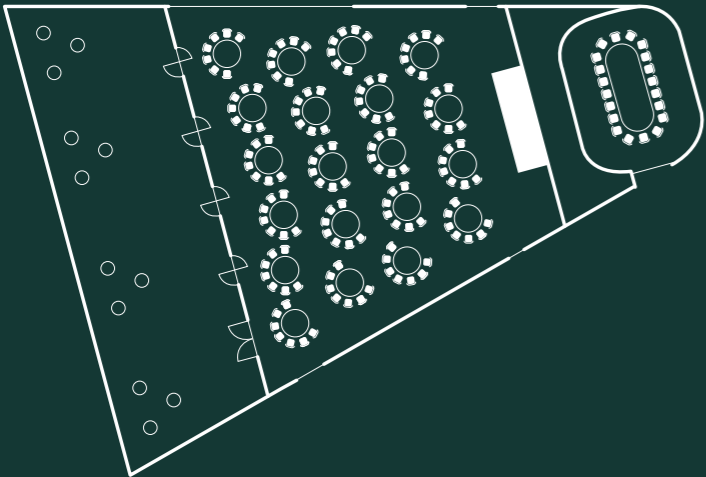







# THE BOARDROOM

---

The Boardroom provides a sophisticated space to meet, collaborate and share ideas.

---

It has the capacity for 20 people and the convenience of proximity to both The Conference Hall, The Stables Restaurant and the luxury onsite accommodation.

With a 100-inch LED TV screen, HD video camera, superior audio-visual equipment creates all the requirements to 'plug and play' with your own laptop for a very simple and seamless set up.

## Features

WIFI

---

100-inch LED TV

---

HD video camera

---

Superior audio reproduction

---

Boardroom

20 pax





# CONFERENCE PACKAGES

## FULL DAY PACKAGE

per person

### Inclusions

- Tea, coffee and water on arrival
- Notepads and pens
- Mints on tables
- Audio visual technology
- WIFI for all delegates
- Video conferencing technology
- Use of flipchart and electronic whiteboard
- Morning and afternoon tea
- Working lunch of sandwiches, wraps and fruit platter

### Add ons

- Audio Visual Operator
- Gourmet catering selections
- Barista coffee all day
- Special dietary requests incur additional costs

## HALF DAY PACKAGE

per person

### Inclusions

- Tea, coffee and water on arrival
- Notepads and pens
- Mints on tables
- Audio visual technology
- WIFI for all delegates
- Video conferencing technology
- Use of flipchart and electronic whiteboard
- Morning tea or afternoon (one only)
- Working lunch of sandwiches and fruit platter

# VENUE HIRE

We recognise that every conference or event is unique and that requirements can vary.

Venue hire fees will be applicable based on your requirements.





# CATERING AND HOSPITALITY

Food brings people together. We celebrate our local produce and suppliers with a touch of elegance.

Willinga Park will tailor your culinary experience either in our private function Restaurant and Bar, Conference Hall, Grand Prix Lounge, or a bespoke experience within the beauty of the Willinga Park grounds. Menus to be provided. Catering quotes will be provided once your requirements have been confirmed.



## THE STABLES RESTAURANT AND BAR

The Stables Restaurant and Bar is near The Conference Hall and The Boardroom and is available for groups larger than 20 people, and a maximum of 70 people.

Enjoy an arrival drink with the beautiful Yamaha C7X Disklavier Enspire piano playing in the background. Your choice of playlist can be downloaded and transformed to piano-style playback, creating a magical atmosphere.

## THE CONFERENCE HALL

The Conference Hall can be transformed into a sophisticated and glamorous gala affair, or a casual and relaxed dinner, and is available for groups larger than 70 people and maximum of 160 people.

In the evening The Conference Hall comes alive with special lighting effects, with natural settings under the stars for dancefloors and pre dinner drinks.

## THE GRAND PRIX LOUNGE

The Grand Prix Lounge is a versatile venue available for groups larger than 20 people and maximum of 60 people.

With two storeys, the Grand Prix Lounge has its own kitchen, two lounge areas, one with a fireplace, and is the perfect venue for long lunches, cocktail parties, summer dinners and break-out spaces.

## BESPOKE CATERING

Our dedicated hospitality team can tailor food and beverage requirements to your needs, and provide some unique suggestions. Minimum spend \$500.

## EVENT SUPPLIERS

We're committed to backing our local suppliers, and we're here to help with any needs you may have. Whether it's a florist, entertainment, event hire, or experienced providers, we can provide recommendations tailored to your preferences.

Disclaimer:  
- Our menus are based on seasonal availability and may be subject to change.  
- Minimum spends may be applicable.

# BREAKFAST, LUNCH & TEAS

Our breakfast and lunch options are vibrant and healthy and will keep your delegates uplifted and fuelled.



## BREAKFAST

### Gourmet Hamper

Our Gourmet Breakfast Hamper includes locally sourced produce and delivered to your luxury Pavilion.

### Continental Buffet

The Classic Continental Buffet is served in the Stables Restaurant

Choose either the Gourmet Hamper or a Continental Buffet to be included in your Conference Package.

### Full Breakfast

The Continental Breakfast plus a hearty hot breakfast served in The Stables Restaurant

## MORNING AND AFTERNOON TEA

Take a break and recharge during your morning or afternoon tea breaks.

## LUNCH TIME

### Working Lunch

A selection of fresh gourmet sandwiches and fruit platter.

### Longer Lunch

Make it a longer lunch and enjoy a share-style menu of two hot dishes.





# DINNER

Enjoy a pre-dinner drink and a relaxed or formal style dinner in The Stables Restaurant or Conference Hall.

Served in The Stables Restaurant for groups larger than 20 people and maximum 70 people. Served in The Conference Hall for groups larger than 70 people and maximum 160 people.



## CANAPÉ

A canapé menu can be designed for on arrival starters and substantial canapé cocktail events.

## FAMILY STYLE DINNER

Two course (select two mains, and one dessert)

Three course (select two mains, and one dessert)

## FORMAL DINING DINNER

Two course (select two main one dessert)

Three course (select two mains, entrées and desserts).

## FAMILY STYLE BBQ

Enjoy a relaxed BBQ dinner under the stars and by the swimming pool.

Two proteins, two salads and one dessert.

## PARRILLA BBQ

Cooked on the Argentine Parrilla over the grill's wood and ember-filled firebox.

Maximum of 40 people by the swimming pool.

Two proteins, three salads and one dessert.

# BEVERAGE PACKAGES

Our Beverage Packages are inclusive of sparkling wine, white wine, red wine, beers and non-alcoholic beverages. Beverages can also be served on consumption. Bespoke beverage packages can be arranged on request.

Willinga Park is fully licensed until 11.00pm. Enquire about our wine lists.



## THE CLASSICS

4 Hour beverage package (beer, wine and sparkling)

ADD ON  
Each additional hour

## SOMETHING LOCAL

4 Hour beverage package (beer, wine and sparkling)

ADD ON  
Each additional hour

## SOMETHING SPECIAL

4 Hour beverage package (beer, wine and sparkling)

ADD ON  
Each additional hour

## CHAMPAGNE ON ARRIVAL

One glass per person, served on arrival.

### ADD ONS

Champagne can be added, or on a consumption basis.

Cocktails on consumption

Cocktails can be pre-ordered or served on consumption.

Core Spirits on consumption

Core Spirits can be added to any package, or on consumption.

Experiences on consumption

Gin Station  
Whiskey Bar  
Spritzers Bar  
Margarita Station

Disclaimer:  
- Our menus are based on seasonal availability and may be subject to change.  
- Minimum spends may be applicable.







9



# TRANQUIL ACCOMMODATION

The freestanding Pavilions provide a luxurious retreat for delegates to enjoy the privacy and comfort.

All Pavilions are self-contained, with spacious elegant interiors and uninterrupted north facing views of the surrounding natural landscape.

Each bedroom has an ensuite with pin code entry, and shared kitchen, laundry and living areas, providing flexibility to accommodate your delegates. Each Pavilion has free WIFI, a well-equipped kitchen, laundry facilities and two parking spaces.

Your delegates will feel re-energised between events with our exclusive use of our facilities.

A heated swimming pool, alfresco dining area, and barbeques are surrounded by meticulously landscaped gardens with close proximity to the Pavilions.



## 2-BEDROOM PAVILION

2 bathrooms

2-bedroom Pavilions	16
Total capacity	32 people

Further accommodation options available on site and next door at Interludes by Willinga Park.

### Add ons

- Split beds - \$50.00 per bed
- Housekeeping - no weekend service, POA.

## 4-BEDROOM PAVILION

3 bathrooms

4-bedroom Pavilions	2
Total capacity	8 people

Further accommodation options available on site and next door at Interludes by Willinga Park.

### Add ons

- Split beds - \$50.00 per bed
- Housekeeping - no weekend service, POA.



# TWO-BEDROOM PAVILION

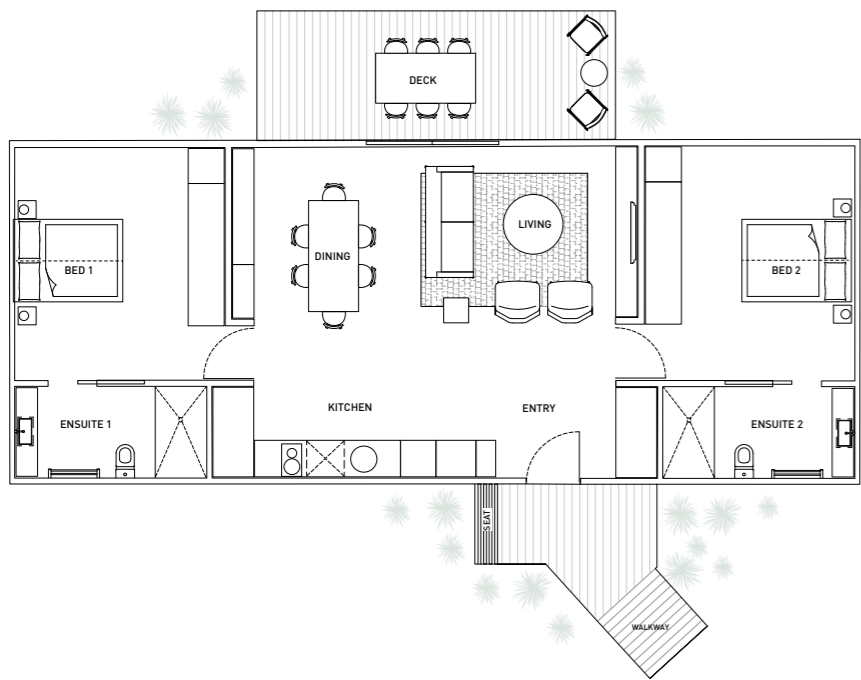

Each 2-bedroom Pavilion offers a spacious 97 sqm of sophisticated luxury

They include a central open plan kitchen, dining and living space which flows seamlessly onto a northern sundeck. Two oversized bedrooms exude indulgence and comfort with a king bed and private ensuite.

## Features

- Inside: 97 sqm

---

- Outdoor deck: 15 sqm

---

- Lockable bedroom with touch pad code

---

- Individual ensuite

---

- Kitchen and laundry facilities

---

- 2 car parking spaces

---

- WIFI

# FOUR-BEDROOM PAVILION

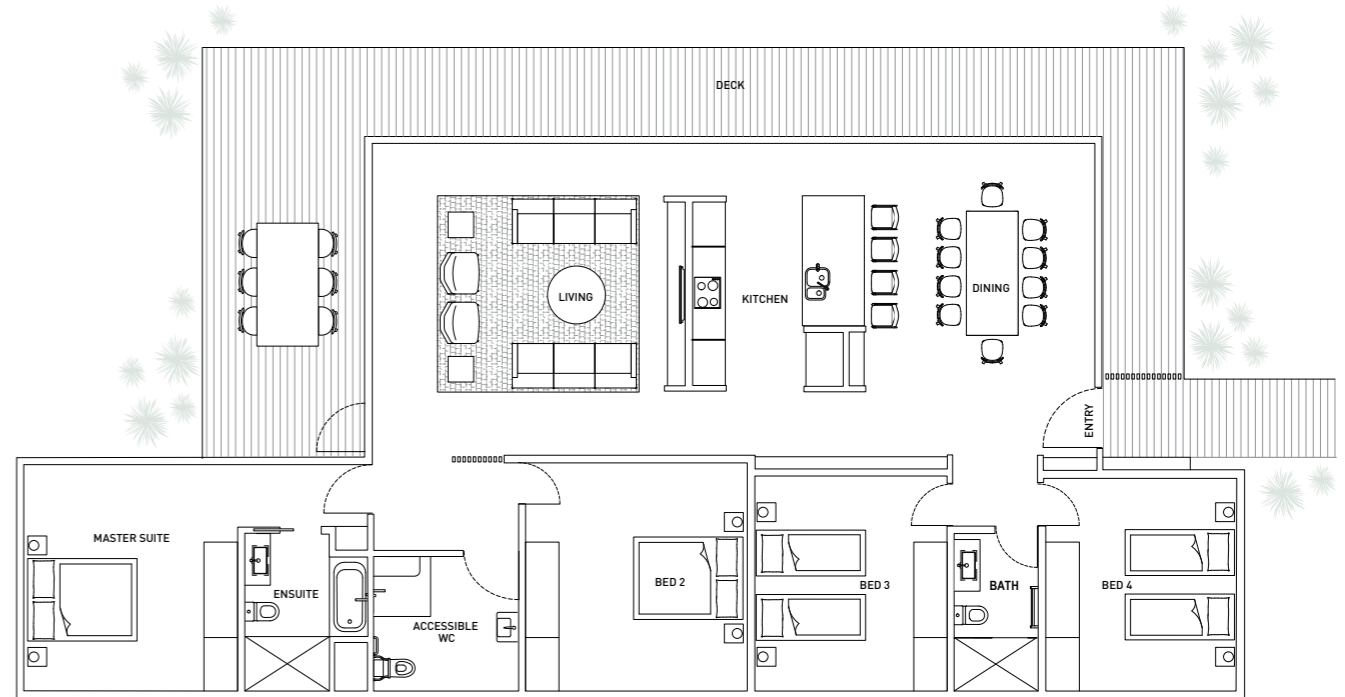

The 4-bedroom Pavilions are perfect for a larger delegate group, offering 200sqm of refined luxury.

An open plan kitchen, dining and living space is surrounded by an expansive outdoor deck with breathtaking northerly views. The oversized bedrooms provide flexibility with the option of a king bed or king single beds and are serviced by an ensuite and two bathrooms.

## Features

- Inside: 200 sqm

---

- Outdoor deck: 65sqm

---

- Lockable bedrooms with touch pad code

---

- King bed and king single options

---

- One ensuite and two bathrooms

---

- Kitchen and laundry facilities

---

- 2 car parking spaces

---

- WIFI



# GARDENS & SCULPTURES

Willinga Park's fusion of art and nature is remarkable. As visitors approach Willinga Park, their initial impression is one of awe, as they encounter the first of many unexpected and thoughtfully scattered art sculptures seamlessly integrated into the natural landscape.



This impressive permanent private sculpture collection features 36 works by both internationally and nationally celebrated artists offering a unique and immersive experience for all who visit.

The artistic journey at Willinga Park spans across various styles and influences, with contributions from well-known Australian, New Zealand, Chinese, and Japanese sculptors. Artists such as Phil Price, Jeff Thompson, Virginia King, Wei Wang, and Haruyuki Uchida have contributed to the

diverse ensemble, adding a playful and dynamic atmosphere to the serene surroundings.

A highlight of the sculpture collection is the imposing five-meter-tall bronze sculpture *Walking* by Wei Wang, greeting visitors upon arrival with its oversized figurine. Additionally, the *Red Balance Beam* by Haruyuki Uchida, crafted from stainless steel and magnet paint, offers a mesmerising spectacle as it subtly sways with the flow of air and human touch, symbolising the invisible forces of gravity and air.

Wandering through Willinga Park's stunning landscape, visitors can explore the winding paths, water features, and striking art installations, creating an immersive experience that transcends the traditional boundaries of art appreciation. The 10-hectare botanic gardens, established in 2010, showcase a native Australian wonderland with a diverse array of trees, plants, and shrubs.

# EXPERIENCES

Bawley Point on the South Coast of New South Wales is a jewel on the Shoalhaven coast and a playground for nature lovers. Sweeping sandy beaches, wild coastlines and unspoilt national parks are all within easy reach of Willinga Park.

Our remarkable location provides an opportunity for your delegates to disconnect from the office, immerse themselves in nature and connect with purpose.

Whatever the purpose, we can tailor a bespoke package that sets your event up for success and makes the most of your time in our beautiful part of the world. Your limitation is only your imagination!

The beautiful and unique venue offers a multitude of possibilities to utilise all areas of the venue for events such as demonstrations and launches.

Within your booking, enjoy the self-guided botanic gardens and sculpture walks, bike rides, or learn about the extensive sustainability program.

## ADD ON - POA

Through strong relationships with local providers, we can help create memorable and authentic experiences. Wake up in the morning to yoga on the beach, hike mountain summits with knowledgeable guides or learn about the area's rich indigenous history.

FOOD & WINE	Cooking masterclass
	Cocktail masterclass
	Wine or beer tastings from local suppliers
	Wine tours at local vineyards
CULTURAL	Acknowledgement of Country and Welcome to Country
	Smoking ceremonies
OUTDOOR	Campfire experience
	Mountain biking
	Hiking trails
	Stand up paddle boarding
	Fishing
	Surfing
WELLNESS	Golf
	Yoga or Tai Chi on the beach or within the natural settings at Willinga Park
	Stretching class
	Mindfulness activities; meditation, breath work, massage



# TRAVELLING TO WILLINGA PARK IS STRAIGHTFORWARD.

# LOCATION

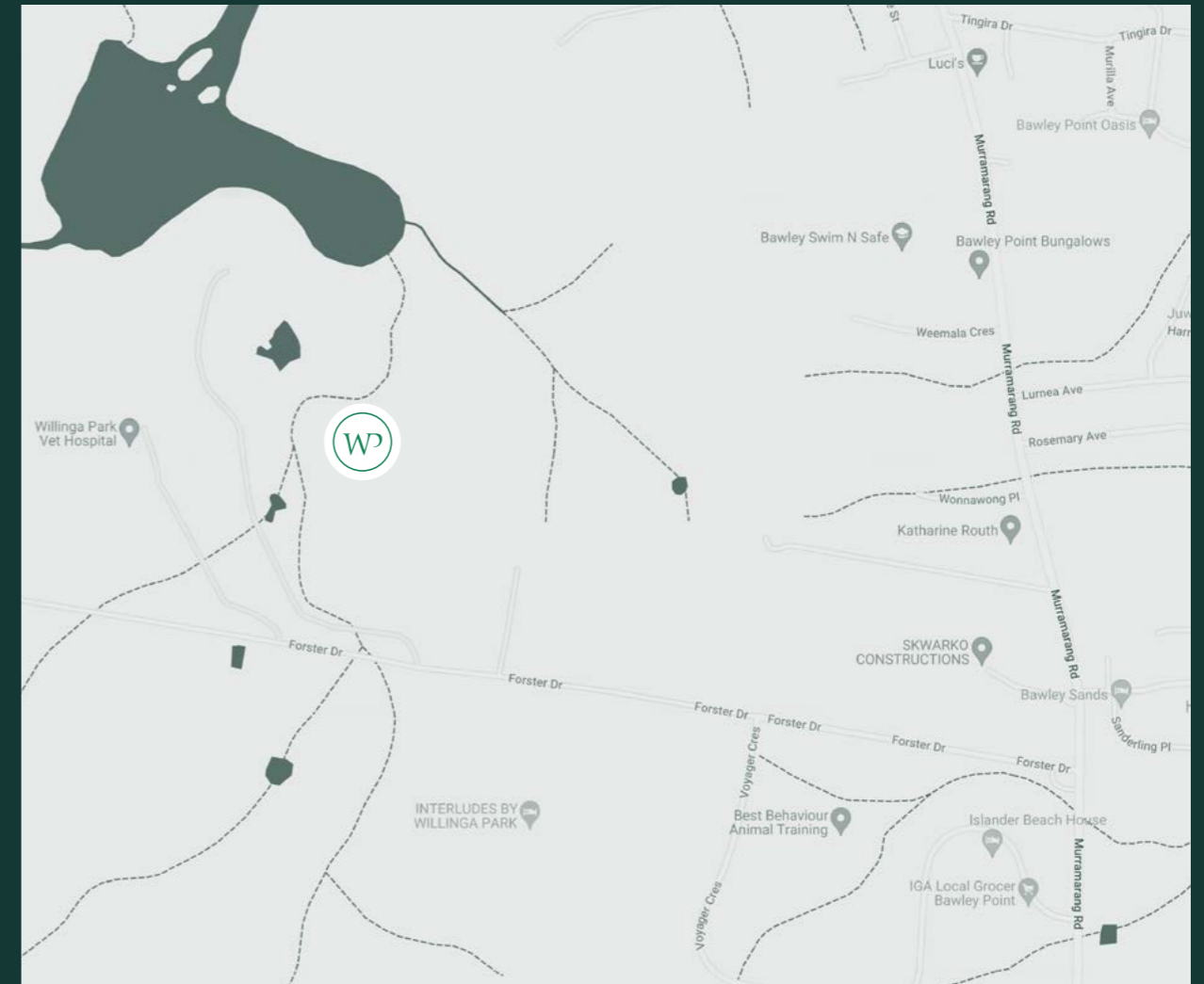

Willinga Park  
134 Forster Drive  
Bawley Point,  
New South Wales 2539

## From Canberra Airport

Northeast of Willinga Park –  
2 hr 20 min bus or car transfer  
via Kings Highway/B52

## Chartered flights to Moruya

Airport – then a  
50 min transfer to  
Willinga Park

## From Sydney Airport:

South of Willinga Park – 3 hr 30  
min bus or car transfer via M1  
and Princes Highway/A1

## Helicopter transfers

direct landing on  
Willinga Park's helipad









WILLINGA PARK

**CONFERENCES**



[WILLINGAPARK.COM.AU](http://WILLINGAPARK.COM.AU)



[facebook.com/willingapark](https://facebook.com/willingapark)



[@willingapark](https://instagram.com/willingapark)